

Founded 1960

BERRIMA DISTRICT HISTORICAL & FAMILY HISTORY SOCIETY INC

NEWSLETTER
No 455 October 2013

PO Box 131 Mittagong NSW 2575 Telephone / Fax 0248 722 169
Website: www.berrimadistricthistoricalsociety.org.au
Email: bdhsarchives@gmail.com

ABN 29 362 616 937

PATRON:	Mayor of Wingecarribee Shire: Councillor Juliet Arkwright
President:	Mr Bruce MOORE 4872 3762 actmoore@bigpond.net.au
Snr Vice President:	Mrs Linda EMERY 4883 4271 lemery75@southernphone.com.au
Jnr Vice President:	Mrs Leonie KNAPMAN 4871 1804
Hon Secretary:	Mr Philip MORTON 4883 7862 flipmort@bigpond.com
Hon Treasurer:	Mrs Patricia DORIS 4872 3313
Archivist:	Mrs Linda EMERY 4883 4271
Curator - Museum:	Mr Bob WILLIAMS 4889 4405
Editor:	Ms Lavinia FORD 4869 4038 lavinias@dodo.com.au
Research Officer:	Mr Max ROGERS 4861 3526 robert.rogers2@bigpond.com



ARCHIVES: Cnr Old Hume Highway and Bowral Road, MITTAGONG.

OPEN: Mondays, Tuesdays 10am-4pm and Saturdays 10am-1pm. Closed Public Holidays.
Library collection contains reference books, journals and newsletters of other societies.

MUSEUM : Market Place, BERRIMA. Tel: 02 4877 1130 Email: berrimamuseum@bigpond.com OPEN: Saturdays, Sundays, NSW Public and School Holidays (except Good Friday, Christmas Day and Boxing Day) 10.00 am to 4.00 pm.

MEMBERSHIP: Any person wanting to join the Society may do so at any stage during the year by completing a form and paying the appropriate fee. Joining Fee \$10.00 - Single \$20.00 - Family \$33.00.

AFFILIATIONS: Royal Australian Historical Society, NSW Association of Family History Societies, Museums Australia Inc & Regional Chapter.

GENERAL MONTHLY MEETING

OCTOBER MEETING: Thursday 24 October 2013 at 2pm
VENUE: Society Research Centre, Old Council Chambers Building, Bowral Road, Mittagong

GUEST SPEAKER: **Ros Dale**
 Society member, Ros Dale, will give a talk based on her soon-to-be-published book on the history of Berrima

AFTERNOON TEA: To be served following the speaker - Members - please bring a plate or a donation.

Inside this month ...

Diary Dates	2
Mittagong Tour	4
Mittagong Maltings	5

And more ...

NOVEMBER AGM: Thursday 28 November 2013 at 2pm
VENUE: Society Research Centre, Old Council Chambers Building, Bowral Road, Mittagong

AFTERNOON TEA: To be served following the speaker - Members - please bring a plate or a donation.



Diary dates

OCTOBER

- Tulip Time
1 **MEMBERSHIP FEES DUE**
8 School holidays conclude
10 Management Committee Meeting
24 General Monthly Meeting

NOVEMBER

- 1 Office Bearer Nominations due
Notices of Motion due
14 Management Committee Meeting
28 **AGM & Monthly Meeting**

DECEMBER

- 12 Management Committee Meeting
13 Christmas Dinner, Dormie House
20 School holidays commence
26 **NO** General Monthly Meeting

JANUARY

- 9 Management Committee Meeting
23 **NO** General Monthly Meeting

Christmas dinner

This year Christmas dinner will be at Dormie House, Moss Vale.

There will be more information in our next newsletter.

Membership fees

Just a reminder that membership fees were due by October 1. If you have forgotten there is still time to renew so you won't miss out on your newsletter.

Nomination and appointment forms

Attention all Office Bearers, Other Committee Members, Appointed Position Holders and prospective nominees. Nomination and Appointment Forms are available at the Archives and Museum and must be lodged with the Secretary by 1 November for consideration at the AGM on 28 November, 2013.

From the President's desk *Bruce Moore*

September has been a month for self-congratulatory behaviour. Before the applause dies down completely, I should mention just a few of the events that took place.

Members are celebrating after hearing of our grant approval by George Souris and the NSW Arts Funding Program who will issue a cheque this week for \$98,452. This now allows the extension to be built already having donations in cash and kind of \$147,000. Work is scheduled to start in early 2014. We still appreciate any further donations which can be made either in person at the Archives, Museum or on line at www.sh1200.org to help fund the exhibition within.



Pru Goward officially acknowledging that the NSW Arts Funding Program has provided the Museum Extension money for the building. She is flanked by Harlan Hall, Bob Williams & Bruce Moore.

On Federal Election Day we appreciated those two brave souls who faced gale-force winds, political snubbing and literary oblivion outside Avoca Hall. They stoically offered Ron Mumford's "Echoes through the Mist" book for sale. Working from a mere card table, Philip anchored a windblown BDHS pennant with two bricks while Carolyn thought of tying herself to a flagpole. Congratulations for their endurance and selling 18 books!

Plaudits also to those background organizers and catering volunteers who are often overlooked, and who provided a veritable feast for Dr. Ian Jack and almost 60 guests who attended the book launch at our Berrima Museum. He did a professorial appraisal of Philip's "Early

Industries in the Berrima District" which meant he was delighted with the effort and saw that it covered most subjects that hadn't been previously published.

Thank you Ros, Carol Nolan and Bro. Bob for giving us such a special tour of Mittagong. (see page 4)

Tool implement identified

In the August issue there was a photo of an implement from the toolbox of Alf Stephens and readers were asked if they could identify its use.



One of our members, Barrie Ingate of Moss Vale, suggests the tool is an iceman's pick that was used for separating and cutting the large blocks of ice used in household ice chests before refrigerators became available in homes.



The square-ended blade was used to separate the blocks in the delivery car; then the pick was used to drag them out of the cart. The blade was also useful in trimming the blocks down to fit in the ice chest.

Perhaps, as Alf Stephens was a builder and carpenter, he found this tool also had other uses.

Thanks to Laurel and Barry for supplying this information and solving the puzzle of what would once have been familiar as an essential tool of trade.

October Meeting guest speaker

ROS DALE

Opening a Window on Berrima's Past

Society member Ros Dale was employed by NSW Corrective Services at the Berrima Correctional Centre in until its closure in 2011.



Following her change of circumstances, Ros made a study of Berrima's history to assist her historical and ghost tours of Berrima. When the information was collected, it became apparent that to remember it, Ros would have to write books about the information gathered. The book to support her historical tours is titled, "Opening a Window on Berrima's Past." This book takes the reader around the lovely village of Berrima, once an important coaching stop on the main road south. The beautiful buildings are explored as are some of their interesting residents.

"Berrima - a very spirited place" is a booklet that Ros was asked to produce by ghost tour participants wanting to take something home as a memento of the tour. These tours have many stories of historical significance with research having been sourced from the personal experiences of Berrima residents and shop employees, historical records and the findings of paranormal team investigations. The information in this booklet is a condensed version of the ghost tour content as some experiences cannot be recorded in entirety. Ros also delivers a presentation on her tours called "The Villains of Yesteryear held at Berrima Gaol" which is not included in the booklet.

Ros will include further information uncovered since writing her historical book including details about social issues of the 1800s, how they were dealt with and, in contrast, what happens in today's society. These issues include poverty and debt collection by a Government agency, public health and the treatment of unmarried mothers. Also mentioned will be the valuable contributions of Richard Matthews, Bridget Curran, Annie Taylor and the strange haunting case of Prison Officer Thomas Craig.

QUARANTINE SCARLET FEVER

All persons are forbidden to enter or leave these premises without the permission of the HEALTH OFFICER under PENALTY OF THE LAW.

German WWI walk of discovery

A fascinating historic walk will bring to life the sites of the German Internment Camp of WWI situated along the banks of the Wingecarribee River at Berrima.



The walk will take place on Wednesday 6 November at 9:45am for a 10:00am start. Participants are to assemble at Berrima District Museum, Market Place.

Bob Williams will lead the walk that is approx. 4km return, taking a leisurely 1½ hours.

Participants are recommended to wear comfortable clothing and shoes as well as a hat and sunscreen and to carry water and mobile phone if you have one.

Bookings are essential; phone Bob on 4889 4405 by Monday 4 November.

Museum's saddlery at Showground

"Transport Through the Ages"

As part of the Moss Vale-Bowral Sesquicentenary celebrations during 2013, a major event will be held at Moss Vale Showground on Saturday 19 October.

On display will be working horses, cars, tractors, truck convoys, machinery and a saddlery.



Wingecarribee Shire Council recently provided funding for our museum volunteers to mount a display of saddlery objects acquired from the workshop of Bowral saddler William (Bill) Oldridge who passed away in 1992.

Detailed photographs were taken of the workshop before it was dismantled and will be displayed, along with a section of the original bench.

The Showground event will be open from 9am to 3pm and food, fun, games and rides will be available.

Come along and support this district heritage display.

Most enjoyable Mittagong tour

Even though the day started with a cold wind blowing, our intrepid band of hardy stalwarts embarked on the much anticipated tour of several Mittagong historic sites on Thursday 19 September. The outing proved to be most enjoyable, interesting and informative.



The affable new owner of the Fitzroy Inn, John Griffin, ensured that the entire establishment was laid bare to our investigations - fine upstairs rooms, the cellars beneath ground, interior courtyard, the old stables converted to a dining area, and extensive gardens.

The self-drive tour then made its way to Rowe Hill cemetery where member Carol Nolan related some stories about early settlers buried there.

Carol then pointed out a grass section and related a little known fact about the burial of many children from the cottage homes at Mittagong.



Burial records show there were 25 children interred from cottage homes between 1886 and 1922. Only nine of these children are marked on the cemetery map, with the remaining 16 graves simply marked as occupied. None of the graves have headstones so these were forgotten children who were in foster care when they died, some as young as 6 months and aged as old as 14 years.

A collection of 25 floral posies had been prepared and tour participants placed them, as a memorial tribute, along the burial site. This was perhaps the only time the little ones had been remembered in 100 years, so was a poignant, touching moment for those present to participate in honouring the forgotten children.



The tour group then proceeded to the nearby Marist Brothers' property known as The Hermitage.

Brother Bill made the group feel most welcome and explained the history and purposes of the religious Order and its establishing of the Mittagong property.

After a lunch stop in the well-appointed Refectory, he showed the group through the two main buildings.

Our Lady of the Hermitage property was established by three Marist Brothers in 1905 at Rowe's Hill in Lower Mittagong. They purchased the property of 400 acres from Dr Edwin Chisholm who bought the property in 1898 from George Rowe. At the time there were several inns and a flour mill in the area.

The property has remained largely intact apart from some minor boundary changes. In 1910 a substantial building was erected for use as the training centre - it ceased in 1984 and became a centre for Christian spirituality. In 1917 another building, the Juniorate, was opened - it closed in 1973 and became a centre for religious retreats for school children.

The Hermitage farm ran a substantial dairy until 1985. It now carries a large beef cattle herd and a vineyard of 35 acres, growing varieties of cool climate wines.



Thanks to Glenda Miskelly for the tour photos.

Launch of Early Industries book

At the Society's museum in Berrima on Saturday 14th September our most recently published book *Early Industries in the Berrima District* was launched by Dr Ian Jack, Associate Professor of History at Sydney University.

Society volunteers turned on a wonderful afternoon tea that was enjoyed by the relaxed gathering of around 60 invited local members and guests.

The new book is based on an exhibition of the same name that opened in late 2009 at the museum. It explains how the landscape and the early explorers' tracks shaped the district; it traces the development of primary and secondary industries and the role of tourism in the district's prosperity. The book explains how the district's names came about and changed.

President Moore opened proceedings by welcoming everyone and called on our Archivist Linda Emery to introduce Dr Ian Jack who was Professor of History for many years and active in the Royal Australian Historical Society, serving a period as its President.

Dr Jack began his address by saying that industrial heritage was close to his heart and thus he was delighted to be asked to launch our book.

He pointed out that the ordinary public image of the Southern Highlands is not dominated by any vision of industry today and it is certainly not the primary bait used to lure tourists to the district. However the district's industrial heritage has been documented. For instance, it forms part of a wider view in Linda Emery's *Pictorial History Southern Highlands* and, much prior to that, in the 1940s several specialised books and pamphlets by Justice Rae Else-Mitchell were the foundation works on local industry.

Several extended studies on particular aspects of local industries have been written since, including the Fitzroy Ironworks, Joadja's oil-shale works and the Mt Gibraltar trachyte quarries.

Dr Jack continued that, despite these specialised studies, a need remained for an overview of all the industries that influenced the development of the area. A need now met with this new book.

While lamenting that the book's thematic glimpse gave short shrift to several key themes, Dr Jack did point out that we all have our special interests and priorities and that the great merit of the book is in its forcing us to reflect on the comparative importance of the various types of industry in the Highlands.

"The importance of the work," Dr Jack said, "is that it is ambitious, embracing so much in a contextual way; it is a highly accessible guide to the economic heritage of the Highlands - which is just as well, as it is the *only* guide."

Now well and truly launched, the Early Industries book, written/produced by Philip Morton with the assistance of several other BDH&FHS members, is available from our premises/website for \$10.



Dr Jack launches the Early Industries book.



Society members at the launch, including archivist Linda Emery (centre).



President Bruce Moore thanks Dr Jack.



Philip Morton

Photos: Bud Townsing

A history of the Mittagong Maltings

Compiled by Philip Morton

Maltings established at Oaklands Estate

The site chosen in 1899 for the establishment of a major malting works at Mittagong was on land that had formed part of Oaklands Estate. This brief historical overview of the Maltings commences with a description of the Estate that had also been known locally as Southey's.

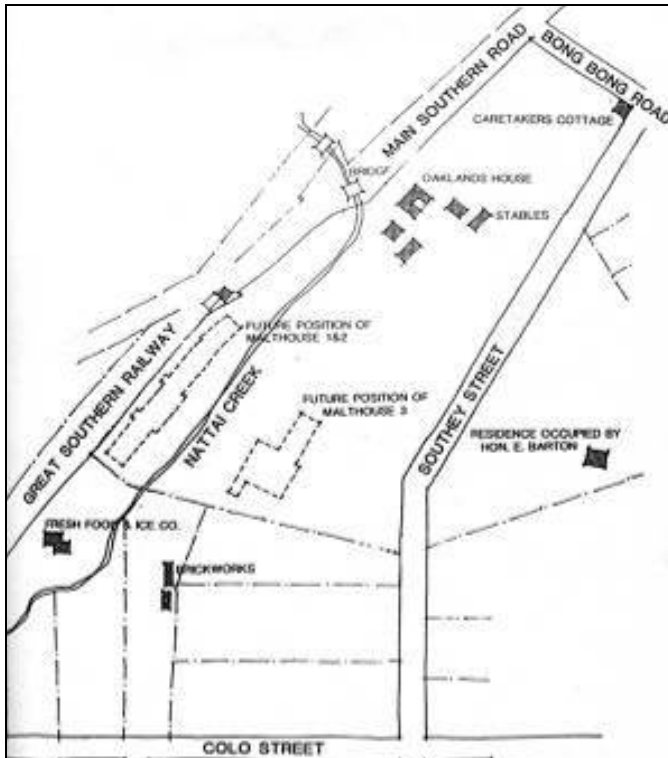

Henry Southey lived on the large estate at Oaklands House, a former inn that had originally opened in 1836 and was known by its first licensees, the Cutters, as Kangaroo Inn. It was of Georgian design with an interior flagged courtyard. Ownership passed to Bartholomew Rush and by 1853 it was known as the Fitz Roy Inn.

From the early 1870s Southey operated it as Oaklands Boarding School until selling the entire estate in 1887 to a Goulburn investment company which proceeded to dispose of it, section by section. At this time the estate was already assuming an industrial character as, at the opposite end from Southey's school, a brickworks and a milk factory were in operation.

The brickworks, one of several in Mittagong during the building boom of the 1880s, was owned by A Bennett and operated by T Dunn. Little is known about it except that it was still in operation in the 1890s and most likely provided bricks for the construction of the Maltings in 1899.

In the early 1880s a milk depot was opened on land leased from Southey and connected by a short rail siding with the main southern line. It was established by the NSW Fresh Food and Ice Company (FF&I), located at Darling Harbour in Sydney and owned by Thomas Sutcliffe Mort.

In 1876 it began to receive milk by rail from farmers in the Berrima District and demand grew so quickly that a local milk depot was needed. Thus at Mittagong the first milk

factory in NSW was established with a cooling room and equipped with a newly invented Danish cream separator. Surplus milk was separated into cream and churned into butter. By 1884 FF&I was railng local milk and butter to Sydney daily and it supplied the first butter to be exported from Australia - one ton was shipped to England.

FF&I closed the Mittagong factory in the late 1880s but continued to rail milk from a depot in Bowral. The Berrima District Farm & Dairy Company acquired the disused factory and operated it as the central butter factory for the district until 1924, when operations were moved to Bowral.

A large undeveloped portion of Oaklands Estate was acquired in 1898 by the Malting Company of NSW for the purpose of producing malted barley, an essential ingredient in the beer-making process.

The following year an imposing yet dignified malthouse was constructed between the railway line and Nattai Creek, with the milk factory and brickworks at its town end and the inn at the other. Over the following 20 years, two additional malthouses, storage silos, ancillary buildings, workshops and a manager's house were constructed.

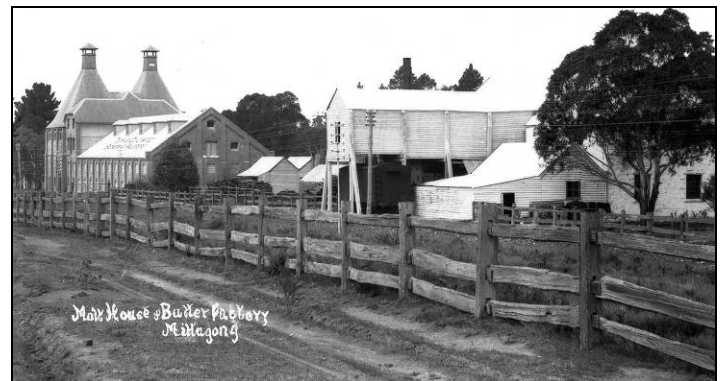

Butter factory and first Malthouse, looking north along Great South Road, c1900.

Until the company residence was ready, the Maltings manager and family resided at the former Fitzroy Inn nearby. Then in 1921 the old inn opened as the Oaklands Guest House and was operated by the Downs family. Being close to the Mittagong sportsground, swimming pool and golf course, it proved most popular with visitors.

It is not difficult to visualise how, in the 1920s, the former Oaklands Estate site was a hive of activity with butter factory, malthouses and a popular guest house.

Why was Mittagong chosen for a Maltings?

In 1898 Arthur Tooth, head brewer at Tooth & Co's Sydney brewery, realised, along with other Sydney businessmen, the desirability of establishing a large-scale malting works to supply barley malt to breweries throughout the state. In association with G S Lintott, a New Zealand maltster, they registered the Malting Company of NSW (Limited) for the purpose of carrying on the business of maltsters and as hop, barley and grain merchants.

They needed a suitable locality to treat the barley grain, as atmospheric conditions, moisture content and temperature are vital factors in malting. Coastal areas did not supply these requirements and so Mittagong was chosen, being reasonably close to the largest market, well situated for transport facilities and with a good water supply.

The Oaklands site was purchased because, being near the rail line, a short siding could be built for trucking barley and malt to and from the malthouse. Close by also was Nattai Creek that could be dammed to provide a steady water supply for the malting process that required large volumes daily. Taking eight months, Stuart Brothers of Sydney constructed the malthouse and it commenced operation in August 1899.

The malting works was a traditional process



The imposing yet dignified buildings at the Mittagong Maltings have long fascinated locals and passers-by.

The Company's Prospectus stated that 'arrangements have been made for securing the services of a manager who has successfully carried on a malting business in New Zealand for many years'. This was George Lintott and the other six directors were all prominent in Sydney's beer, wine and spirit trade with close connections to Tooth & Co.

Two of the directors were Tooth & Co employees: W B Mitchell and Arthur W Tooth, who was head brewer. The Sydney press reported that the new maltings product would be 'mainly absorbed by Messrs. Tooth & Co, by whom the enterprise was practically initiated'.

The Prospectus confidently stated that the venture was 'likely to prove an exceedingly lucrative investment' and investors agreed. Within 24 hours of the company being floated, all 30,000 one-pound shares were sold.

Chairman of the Board was George Judah Cohen, a prominent Sydney banker, financier and company director who had a reputation for financial acumen and hard work. He had been Chairman of Tooth & Co from 1889, and stayed in that role until 1929.

Arthur W Tooth was undoubtedly influential in the selection of the site for the Maltings. His country residence was at Mittagong and now forms part of Frensham School, housing the library.

The malthouse comprised one barley floor, grading and cleaning machinery, two germinating floors and two kilns. The labour force was recruited locally and from Sydney. Local brickworks supplied at least some of the bricks. A new rail siding was completed in September 1899.

The Company hoped to stimulate farmers to cultivate more barley and thus reduce the dependence on expensive imported malts, but did not receive very great support from local barley growers. Most of the raw grain still had to be imported from New Zealand.

Efforts to encourage cultivation bought little response and, by 1903, the shortage of grain was such that the Company suspended operations until the following year. In 1905 the Company accepted an offer from Tooth & Co to purchase the assets and the original concern was wound up.

Tooth & Co vertically integrated the Mittagong site into its own brewing operations and progressively expanded the plant's capacity to meet forecast growth. The original malthouse was duplicated in 1906 with a mirror-image structure on its northern side. Large malt storage silos were provided in 1907.

The barley growing campaign continued, this time bringing about such an increase in supplies that a new grain store was erected in 1913. Then in 1916 a third malting unit was erected across the creek and the entire works employed an average of 27 men working up to four shifts daily.



From 1916 until 1942 the three malthouses were in more or less continuous production with additional ancillary buildings erected and improvements in amenities provided. A light rail and pedestrian bridge provided a crossing point over the creek to link the units.

With flowing creek and water ponds, a bucolic, park-like setting was deliberately created to add romance to an industrial complex that contributed to a most appealing end product - well-brewed beer.

This bucolic setting was not matched, however, by the working conditions for the labourers in the malthouses - to be dealt with in next month's article.

To make beer, brewers use water and barley to create a sweetened liquid (called the wort), which they flavor with hops, then ferment with yeast. This process turns a field of golden grains into refreshing beer. The basic process may be simple but the execution is highly sophisticated.

To produce the malted barley, the Mittagong complex used a traditional English floor system that was labour intensive, expensive and a highly specialised trade learned only from direct experience.

Even though more modern methods came into use, the traditional process endured at Mittagong, reflecting the conservatism of the early Australian brewing industry that had its roots in England where traditional and closely guarded unique methods produced the finest beers.

The process carried out at Mittagong was, therefore, more of an art than a science and relied heavily upon the highly specialised and traditional, unique skills of the head maltster.

To be continued next month

DIARY DATES

THURSDAY	10	OCT	Management Committee Meeting	
THURSDAY	24	OCT	Monthly General Meeting	2:00pm at the Historical Society
THURSDAY	14	NOV	Management Committee Meeting	
THURSDAY	28	NOV	Monthly Meeting and AGM	2:00pm at the Historical Society
THURSDAY	12	DEC	Management Committee Meeting	
FRIDAY	13	DEC	Christmas Dinner	Dormie House, Moss Vale
THURSDAY	26	DEC	NO Monthly General Meeting	
THURSDAY	9	JAN	Management Committee Meeting	
THURSDAY	23	JAN	NO Monthly General Meeting	

If undelivered return to:

Berrima District Historical & Family History Society Inc
PO Box 131
MITTAGONG NSW 2575
Berrima District Historical & Family History Society Inc
Newsletter
Print Post Approved
PP100001055

**SURFACE
MAIL**

**POSTAGE
PAID
AUSTRALIA**

THE BERRIMA DISTRICT HISTORICAL AND FAMILY HISTORY SOCIETY NEWSLETTER

is proudly supported by the following organizations that encourage the work of our Society in collecting, preserving and maintaining the history of the Southern Highlands.

*Boral
Hypercet Printing
Retravisio/Home Hardware, Mittagong
Springetts Arcade*